

APARTMENT TYPE - 2B-2A		
NO.	NAME	AREA
001	KITCHEN / LIVING	37.3 m <sup>2</sup>
002	STORAGE	2.7 m <sup>2</sup>
003	WC	3.7 m <sup>2</sup>
004	DOUBLE BEDROOM	11.8 m <sup>2</sup>
005	EN-SUITE	2.7 m <sup>2</sup>
006	TWIN BEDROOM	14.8 m <sup>2</sup>
007	STORAGE	4.1 m <sup>2</sup>
008	STORAGE	1.3 m <sup>2</sup>
<b>APARTMENT TOTAL AREA</b>		<b>80.6 m<sup>2</sup></b>

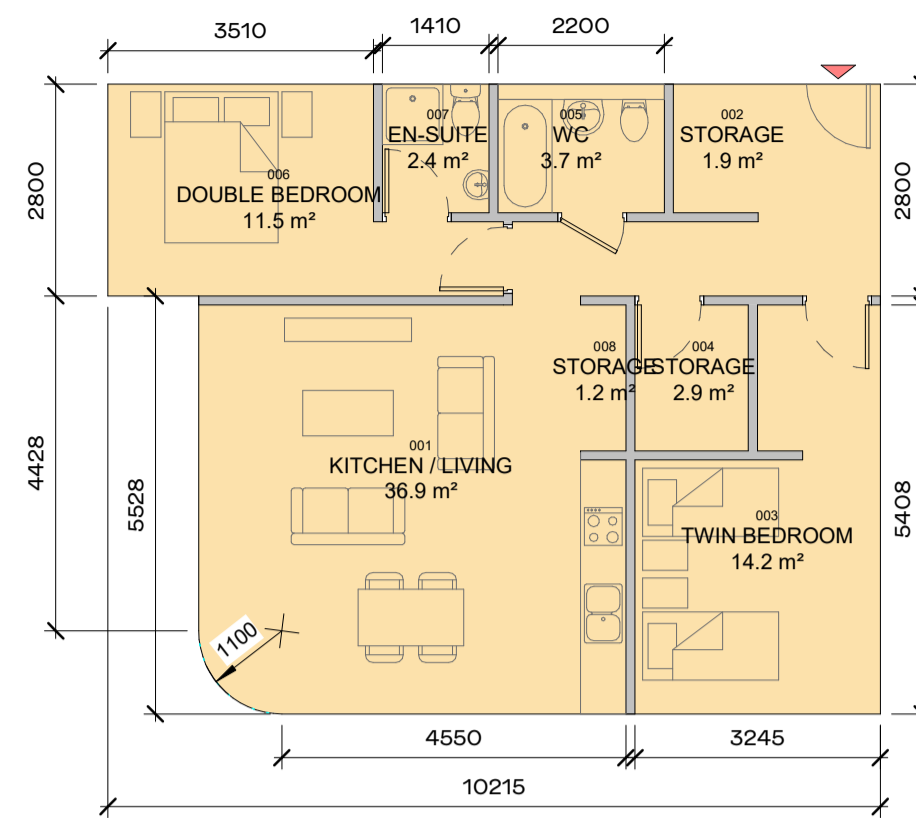

APARTMENT TYPE - 2B-4A		
NO.	NAME	AREA
001	KITCHEN / LIVING	36.9 m <sup>2</sup>
002	STORAGE	1.2 m <sup>2</sup>
003	STORAGE	2.9 m <sup>2</sup>
004	TWIN BEDROOM	14.2 m <sup>2</sup>
005	EN-SUITE	2.4 m <sup>2</sup>
006	WC	3.7 m <sup>2</sup>
007	STORAGE	1.9 m <sup>2</sup>
008	DOUBLE BEDROOM	11.5 m <sup>2</sup>
<b>APARTMENT TOTAL AREA</b>		<b>80.3 m<sup>2</sup></b>

80.6 m<sup>2</sup>  
1 APARTMENT TYPE - 2B-2A  
1:100

80.3 m<sup>2</sup>  
2 APARTMENT TYPE - 2B-4A  
1:100

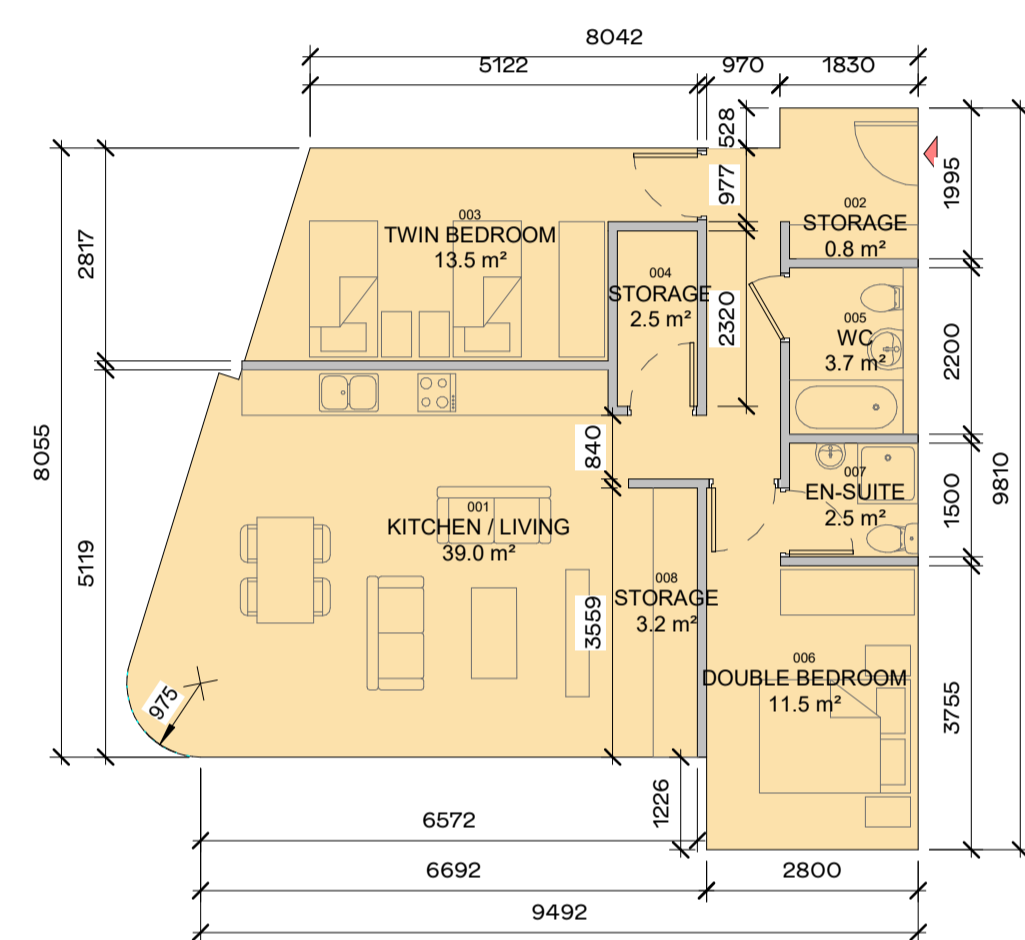

APARTMENT TYPE - 2B-5A		
NO.	NAME	AREA
001	KITCHEN / LIVING	39.0 m <sup>2</sup>
002	STORAGE	0.8 m <sup>2</sup>
003	TWIN BEDROOM	13.5 m <sup>2</sup>
004	STORAGE	2.5 m <sup>2</sup>
005	WC	3.7 m <sup>2</sup>
006	DOUBLE BEDROOM	11.5 m <sup>2</sup>
007	EN-SUITE	2.5 m <sup>2</sup>
008	STORAGE	3.2 m <sup>2</sup>
<b>APARTMENT TOTAL AREA</b>		<b>80.3 m<sup>2</sup></b>

80.3 m<sup>2</sup>  
3 APARTMENT TYPE - 2B-5A  
1:100

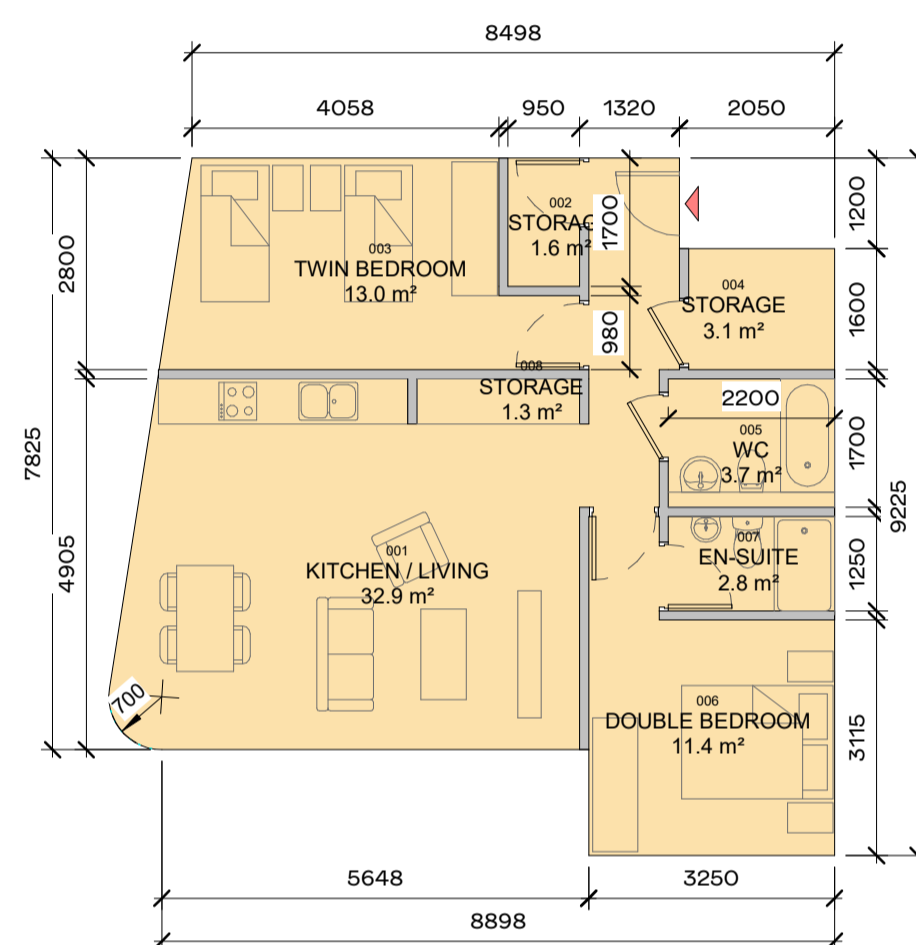

APARTMENT TYPE - 2B-5B		
NO.	NAME	AREA
001	KITCHEN / LIVING	32.9 m <sup>2</sup>
002	STORAGE	1.6 m <sup>2</sup>
003	TWIN BEDROOM	13.0 m <sup>2</sup>
004	STORAGE	3.1 m <sup>2</sup>
005	WC	3.7 m <sup>2</sup>
006	DOUBLE BEDROOM	11.4 m <sup>2</sup>
007	EN-SUITE	2.8 m <sup>2</sup>
008	STORAGE	1.3 m <sup>2</sup>
<b>APARTMENT TOTAL AREA</b>		<b>73.2 m<sup>2</sup></b>

73.2 m<sup>2</sup>  
4 APARTMENT TYPE - 2B-5B  
1:100

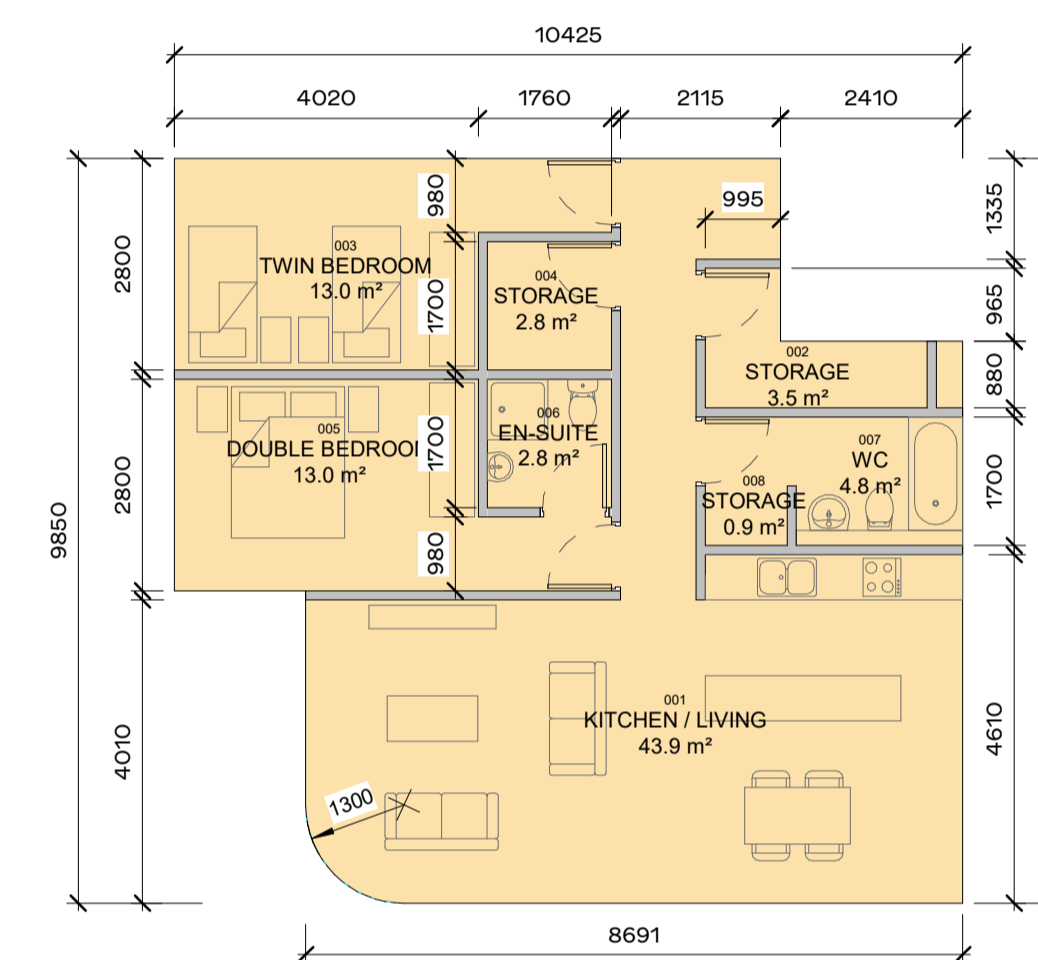

APARTMENT TYPE - 2B-6B		
NO.	NAME	AREA
001	KITCHEN / LIVING	43.9 m <sup>2</sup>
002	STORAGE	3.5 m <sup>2</sup>
003	TWIN BEDROOM	13.0 m <sup>2</sup>
004	STORAGE	2.8 m <sup>2</sup>
005	DOUBLE BEDROOM	13.0 m <sup>2</sup>
006	EN-SUITE	2.8 m <sup>2</sup>
007	WC	4.8 m <sup>2</sup>
008	STORAGE	0.9 m <sup>2</sup>
<b>APARTMENT TOTAL AREA</b>		<b>89.3 m<sup>2</sup></b>

89.3 m<sup>2</sup>  
7 APARTMENT TYPE - 2B-6B  
1:100

ALL APARTMENT TYPES SHOULD BE READ IN CONJUNCTION WITH DRAWING NO.S P1601, P1602, P1603, P1604 AND HOUSING QUALITY

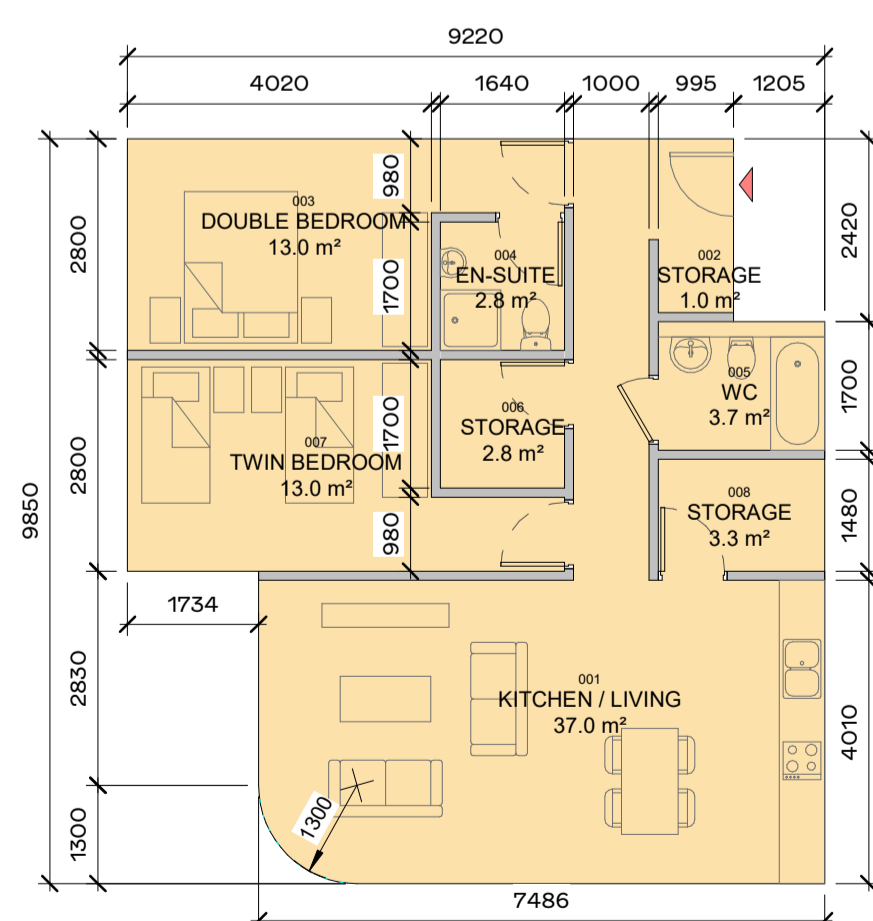

APARTMENT TYPE - 2B-6A		
NO.	NAME	AREA
001	KITCHEN / LIVING	37.0 m <sup>2</sup>
002	STORAGE	1.0 m <sup>2</sup>
003	DOUBLE BEDROOM	13.0 m <sup>2</sup>
004	EN-SUITE	2.8 m <sup>2</sup>
005	WC	3.7 m <sup>2</sup>
006	STORAGE	2.8 m <sup>2</sup>
007	TWIN BEDROOM	13.0 m <sup>2</sup>
008	STORAGE	3.3 m <sup>2</sup>
<b>APARTMENT TOTAL AREA</b>		<b>80.5 m<sup>2</sup></b>

80.4 m<sup>2</sup>  
5 APARTMENT TYPE - 2B-6A  
1:100

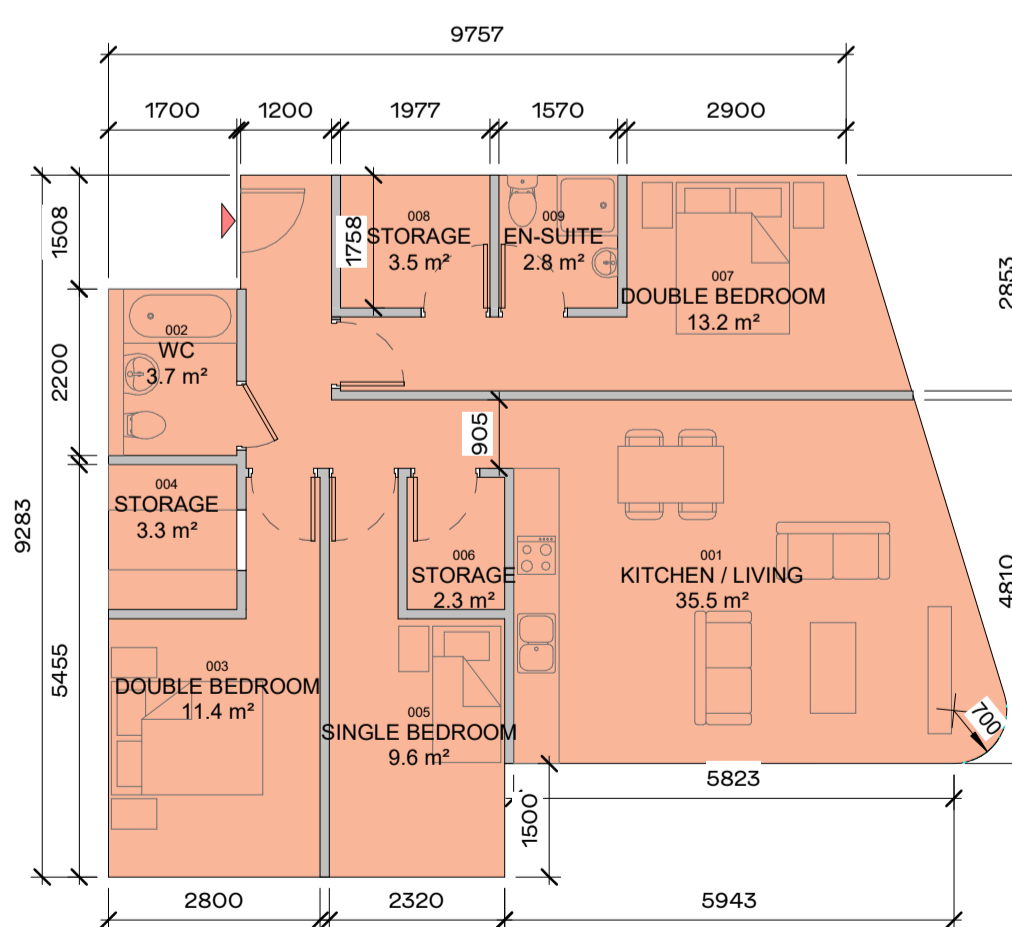

APARTMENT TYPE - 3B-1A		
NO.	NAME	AREA
001	KITCHEN / LIVING	37.8 m <sup>2</sup>
002	WC	3.7 m <sup>2</sup>
003	TWIN BEDROOM	12.4 m <sup>2</sup>
004	STORAGE	2.8 m <sup>2</sup>
005	SINGLE BEDROOM	8.6 m <sup>2</sup>
006	STORAGE	3.2 m <sup>2</sup>
007	DOUBLE BEDROOM	11.4 m <sup>2</sup>
008	STORAGE	3.2 m <sup>2</sup>
009	EN-SUITE	2.8 m <sup>2</sup>
<b>APARTMENT TOTAL AREA</b>		<b>90.2 m<sup>2</sup></b>

90.2 m<sup>2</sup>  
6 APARTMENT TYPE - 3B-1A  
1:100

REV	DATE	DESCRIPTION	CHK	DRN
P2	26/11/2019	ISSUED FOR PLANNING APPROVAL	DB	OJ
P1	08/08/2019	ISSUED FOR PAC REQUEST	DB	OJ

STATUS CODE DESCRIPTION

ISSUED FOR PLANNING APPROVAL

CLIENT

Atlas GP Limited

PROJECT

Project Claremont

DRAWING

APARTMENT TYPES  
SHEET 3 OF 4

PROJECT NUMBER	DATE
950520	26/11/19

SCALE@ A1:	DRAWN/CHECKED:
1: 100	OJ/ DB

REVISION	DRAWING NUMBER	STATUS CODE:
P2	CLR-HJL-XX-XX-DR-A-1603	A1

Henry J Lyons